

Please complete this form and send it to

Name of Contact Person: Ms. Warisa Rattanawongkot and Mr. Disorn Boonpokkrong
N.C.C. Management and Development Co., Ltd. (Exhibitor Organizer/EO Department)
60 Queen Sirikit National Convention Center, Ratchadaphisek Road, Khlong Toei Sub-district,
Khlong Toei District, Bangkok 10110, Thailand
Tel.: +66 2229 3511 and 3536
E-mail: opt02@nccexhibition.com

The organizer has assign N.C.C. Management and development Co., Ltd (EC) to build standard booth. Please fill in form F3 for your booth name and equipment for standard space. However, if exhibitors don't want any equipment in standard space, it means you disclaim this list, you can't exchange it for money or compensate for other things. And you not submit this form in **18 July, 2024**

The organizer has all the right reserved to build structure of standard booth with standard equipment. And you're your booth name according to registration form. In case, you didn't fill in this form and submit it by the due date.

Please fill your Brand/Company name in blank space 1 character per space but not exceed to 24 character. This sticker will attached in front of your booth and is 10 cm. in height, along with your booth number aside.

Please scan this QR code and fill in this Form



Or click this link >> <https://forms.gle/tdbqKsABRYX9VUTy6>

Remark This form for exhibitor who reserve standard booth only.

Example: Picture of standard booth in Pet Expo Championship 2024 size 3x3 Metres

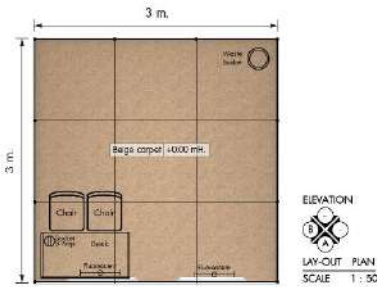
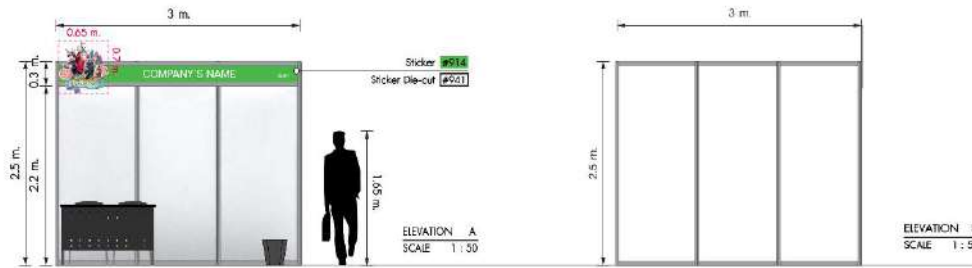

Walk-on package Entitlement

No.	Stand area In sqm.	Size	4	6	9
F-0-1	Fluorescent	-	2	2	2
	Socket 5 amp	-	1	1	1
	Not for lighting	-			
	Desk	-	1	1	1
	Fiber Chairs	-	2	2	2
	Waste Basket	-	1	1	1
	Beige Carpet	-			



Standard booth size 3.00 x 3.00 x 2.50 metres (Total 9 Sqm.) consist of :

- 3 sides of partition (System-built) 3 metres width , 3 metres length , 2.50 metres height
- 1 of Fascia Board and 1 sticker of your brand/company name , You will received 2 sticker if you reserve corner booth (Only character No logo).
- The organizer will specify your brand/company name according to your registration form. If you want to use another name please fill in F3 form.
- Beige Carpet in your booth size 9 Sqm.
- 1 Unit of Reception desk
- 2 Unit of Fiber chairs
- 1 Unit of Waste Basket
- 2 Fluorescent bulb (LED) 14 Watt (For install in standard booth only).
- 1 Unit of Socket 5 Amps (1,000 Watt) 220 Volts (Not allowed to use with lighting equipment)

Example: Picture of standard booth in Pet Expo Championship 2024 size 3x2 Metres

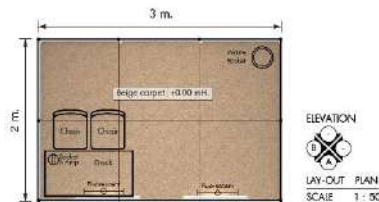
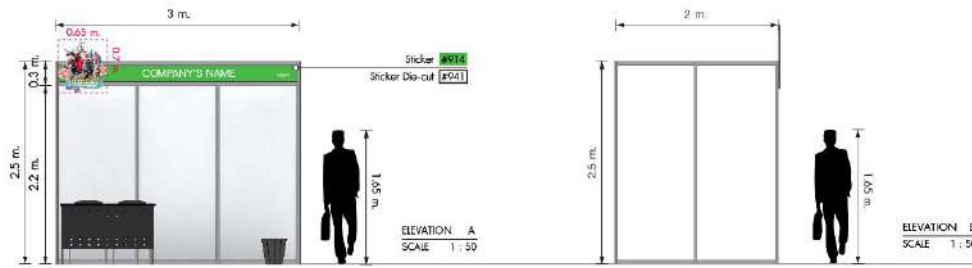

Walk-on package Entitlement

No.	Stand area in sqm.	Size	4	6	8
1-2	Fluorescent	-	2	2	2
3	Socket 5 amp <i>** Not for lighting</i>	-	1	1	1
	Desk	-	1	1	1
	Fiber Chairs	-	2	2	2
	Waste Basket	-	1	1	1
	Beige Carpet	-	-	-	-



Standard booth size 3.00 x 2.00 metres (Total 6 Sqm.) consist of :

- 3 sides of partition (System-built) 3 metres width , 2 metres length , 2.50 metres height
- 1 of Fascia Board and 1 sticker of your brand/company name , You will received 2 sticker if you reserve corner booth (Only character No logo).
- The organizer will specify your brand/company name according to your registration form. If you want to use another name please fill in F3 form.
- Beige Carpet in your booth size 6 Sqm.
- 1 Unit of Reception desk
- 2 Unit of Fiber chairs
- 1 Unit of Waste basket
- 2 Fluorescent bulb (LED) 14 Watt (For install in standard booth only).
- 1 Unit of Socket 5 Amps (1,000 Watt) 220 Volts (Not allowed to use with lighting equipment)

Example: Picture of standard booth in Pet Expo Championship 2024 size 2x2 Metres

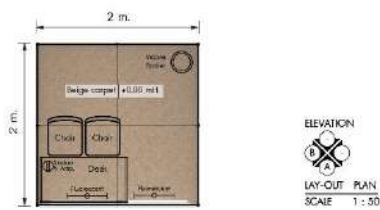
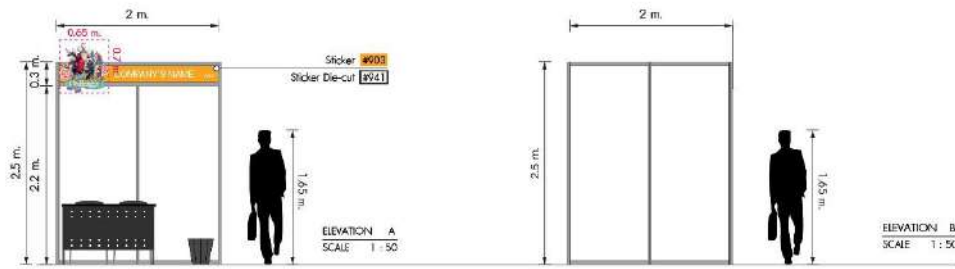

Walk-on package Entitlement

No.	Stand area In sqm.	Size	4	8	9
1-4	Fluorescent	-	2	2	2
5	Socket 5 amp No lighting	-	1	1	1
	Desk	-	1	1	1
	Fiber Chairs	-	2	2	2
	Waste Basket	-	1	1	1
	Beige Carpet	-			



Standard booth size 2.00 x 2.00 metres (Total 4 Sqm.) consist of :

- 3 sides of partition (System-built) 2 metres width , 2 metres length , 2.50 metres height
- 1 of Fascia Board and 1 sticker of your brand/company name , You will received 2 sticker if you reserve corner booth (Only character No logo).
- The organizer will specify your brand/company name according to your registration form. If you want to use another name please fill in F3 form.
- Beige Carpet in your booth size 4 Sqm.
- 1 Unit of Reception desk
- 2 Unit of Fiber chairs
- 1 Unit of Waste Basket
- 2 Fluorescent bulb (LED) 14 Watt (For install in standard booth only).
- 1 Unit of Socket 5 Amps (1,000 Watt) 220 Volts (Not allowed to use with lighting equipment)